

DESIGN DEVELOPMENT PLAN  
BRISTOL STREET SOUTH  
CITY OF NEWPORT BEACH  
CALIFORNIA

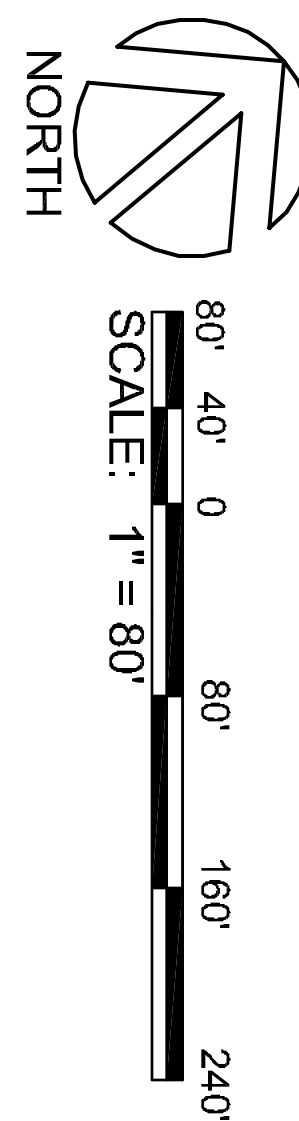

- SCREEN PLANTING BETWEEN ENCLOSURE AND FENCE (D)
- 30'-0" B.O.C. WIDE PLANTING AREA (A)
- 16'-0" B.O.C. WIDE PLANTING AREA (B)
- 0'-0" B.O.C. WIDE PLANTING AREA AT CORNER (B)
- 24'-0" B.O.C. WIDE PLANTING AREA (A)
- 10'-0" B.O.C. WIDE PLANTING AREA (B)
- 8'-0" WIDE B.O.C. ASPHALT PAVING AT OFF-RAMP (C)
- EXISTING ASPHALT NOSING TO REMAIN PROTECTED IN PLACE AT OFF-RAMP
- 35'-0" WIDE B.O.C. PLANTING AREA (A)
- LONG UNIFORM 35'-0" B.O.C. WIDE PLANTING AREA (A)
- 20'-0" B.O.C. WIDE PLANTING AREA VARYING TO JAMBOREE ROAD. (A)

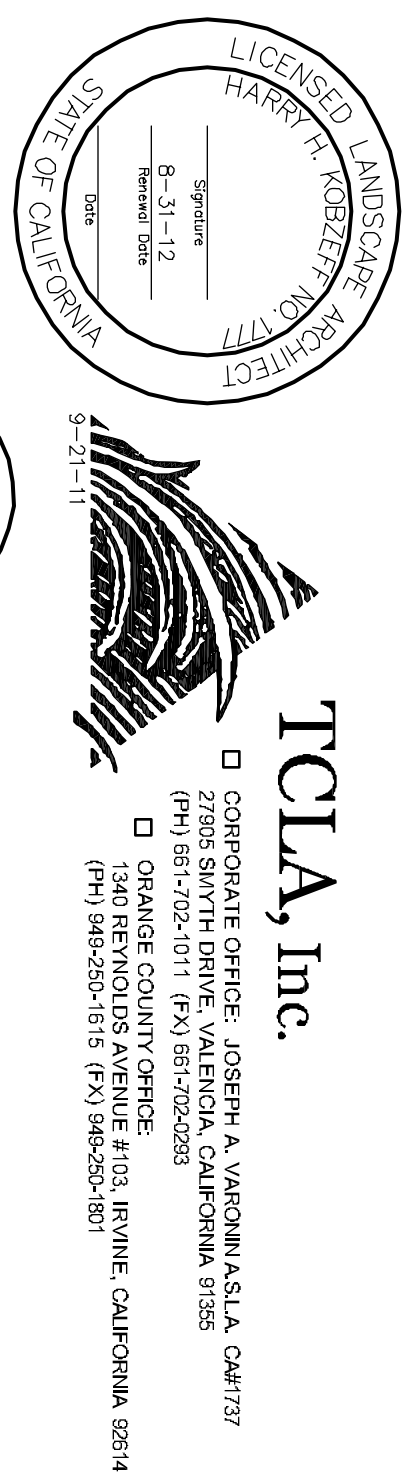
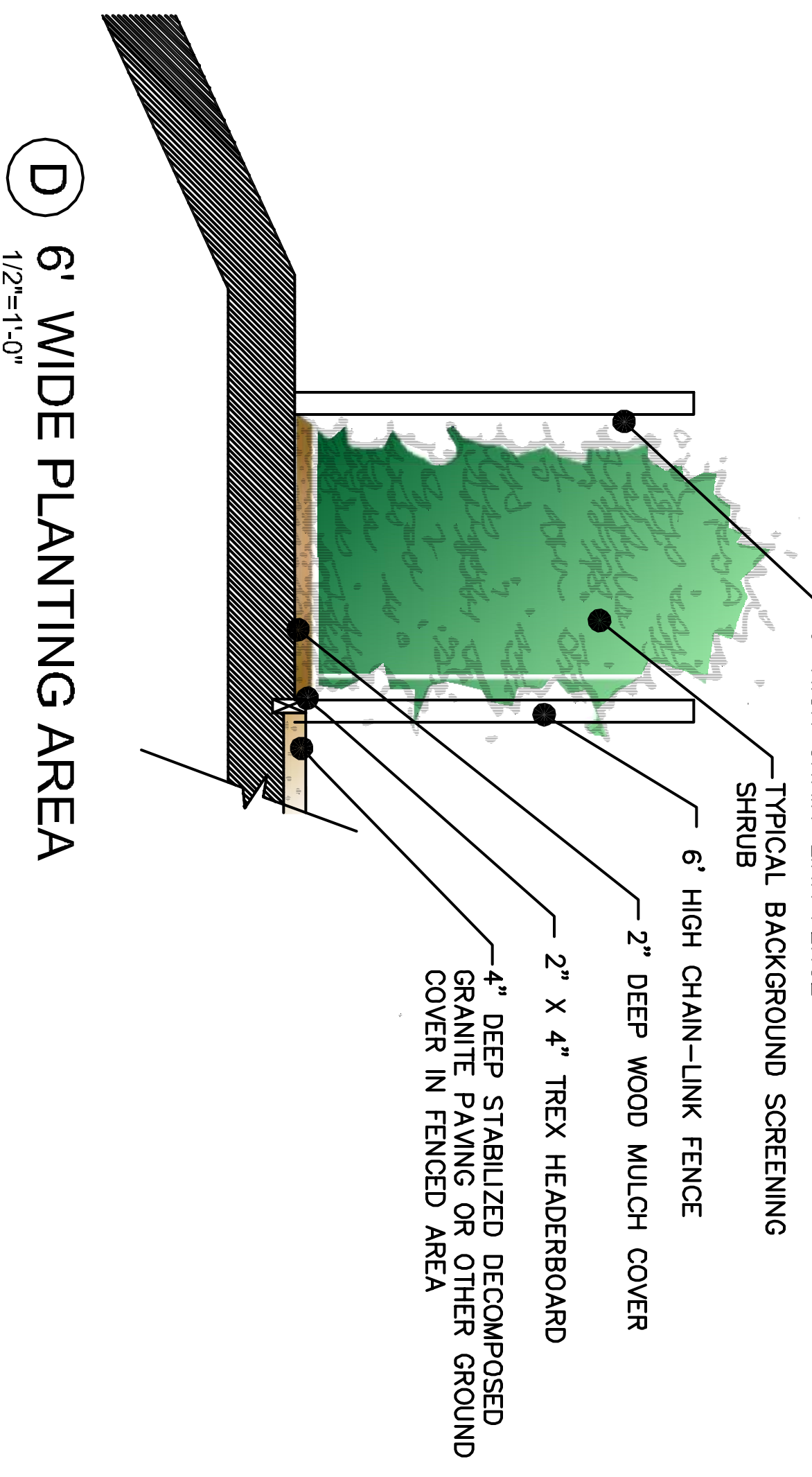
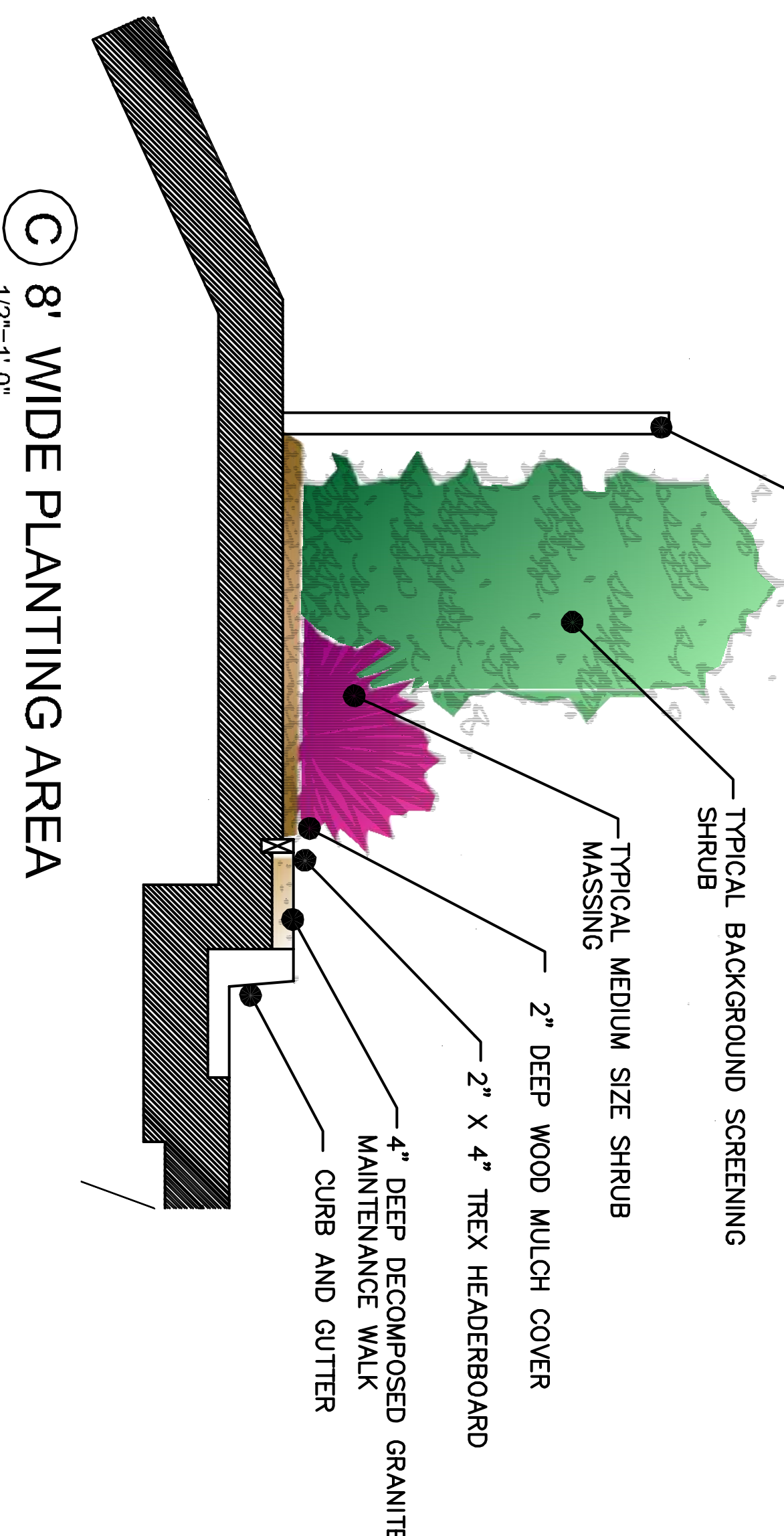
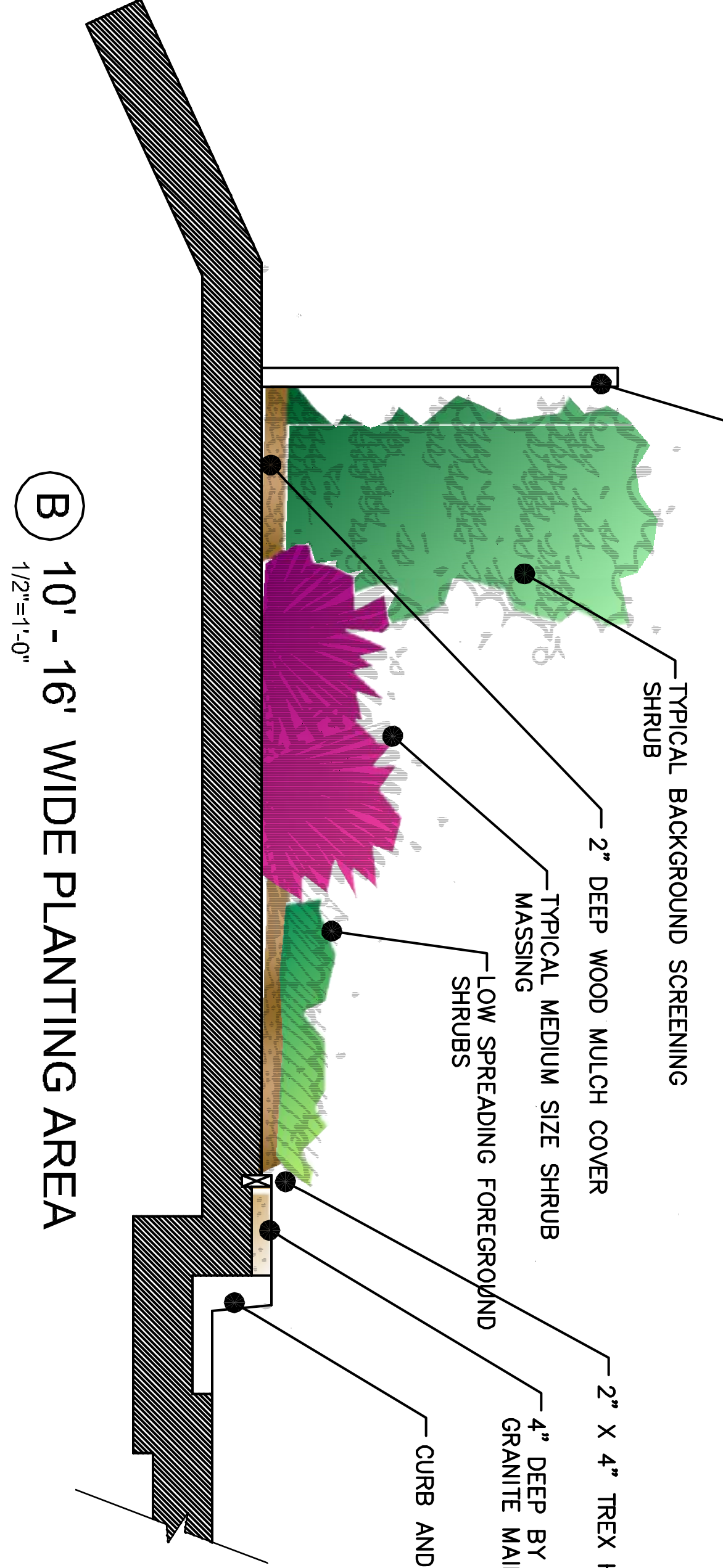
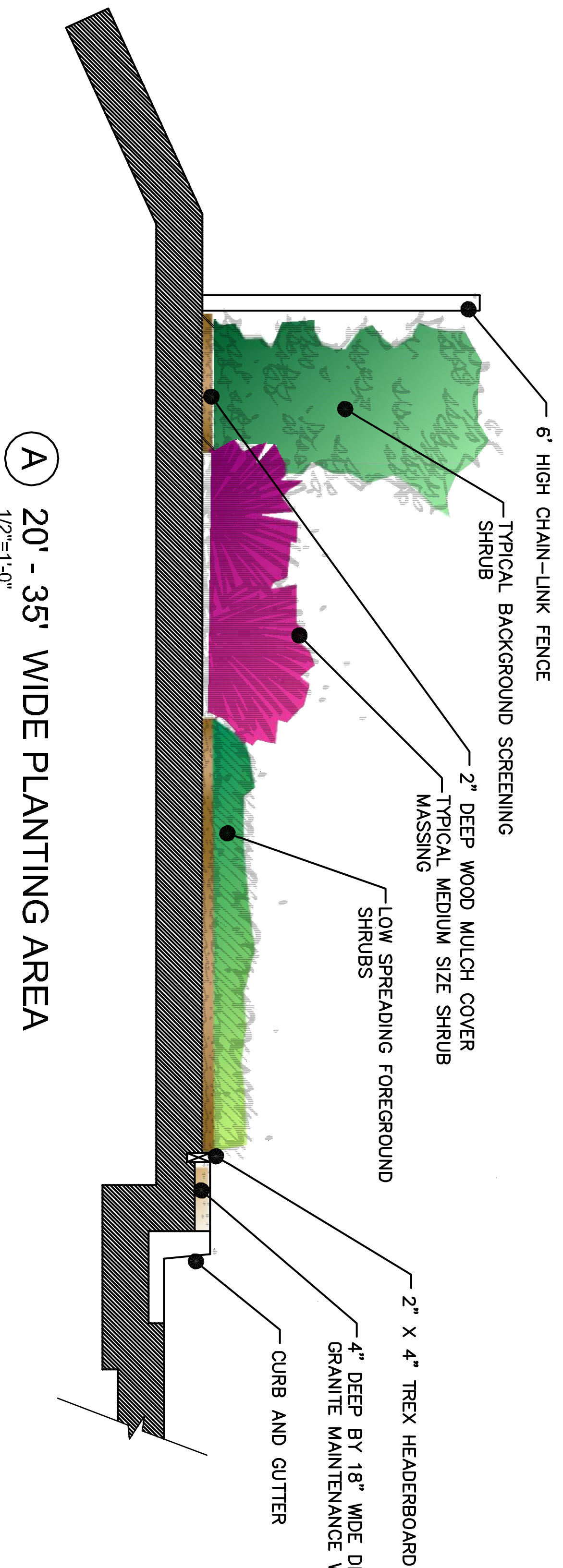
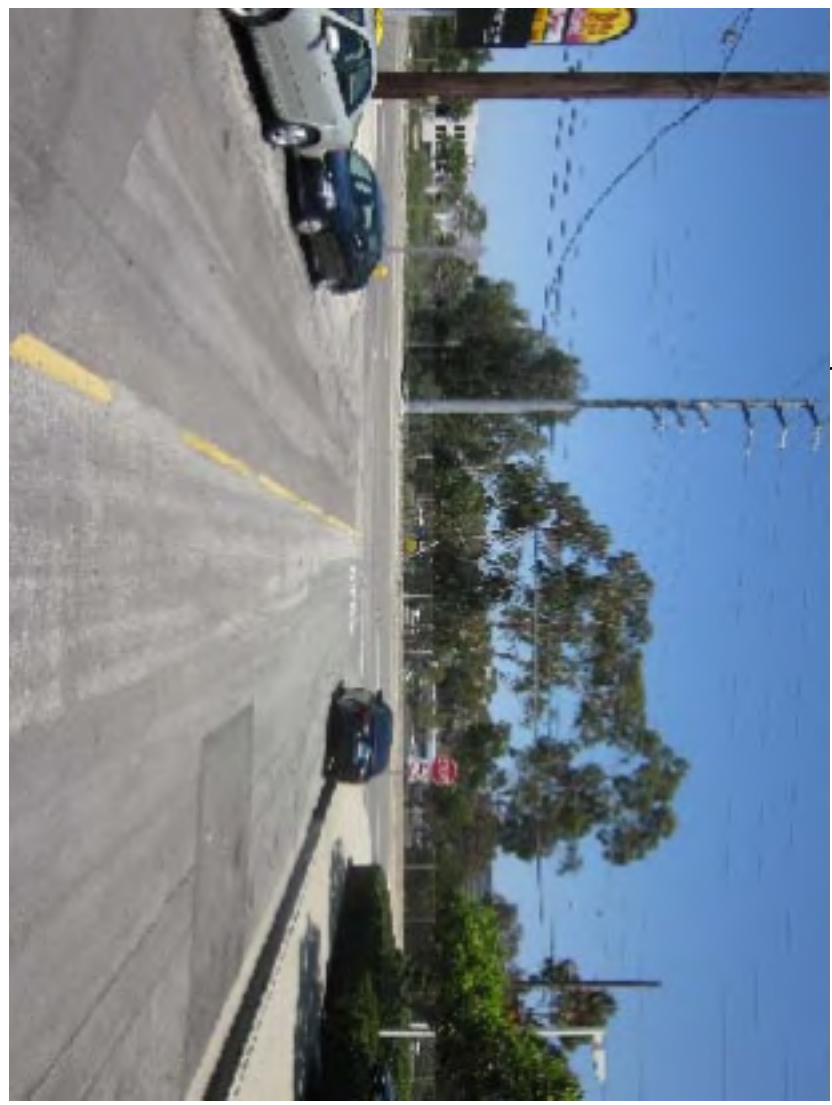

SHRUB OR MIXED OPTION