

NOTES:

1. ADDITIONAL COLD PLANING MAY BE REQUIRED AS DETERMINED BY THE ENGINEER.
2. COLD PLANING AND PAVING SHALL BE REQUIRED WHEN CONSTRUCTION JOINTS OR EXISTING TRENCH LINES ARE WITHIN 5' OF PROPOSED CONSTRUCTION JOINS.
3. RESTRIPE TRAFFIC LANES/MARKINGS WITHIN REMOVAL AREA AND ANY OTHER TRAFFIC STRIPING DAMAGED DURING CONSTRUCTION.
4. CONCRETE PAVEMENT RESTORATION SHALL BE DOWELED PER STD 106-A. 8" THICK MINIMUM CLASS 560-C-3250 WITH EPOXY COATED #4 DOWELS, 18" O.C.
5. SEE STATE OF CALIFORNIA DEPARTMENT OF WATER RESOURCES WATER WELL STANDARDS BULLETIN 74-81 AND 74-90 FOR WELL DESTRUCTION AND SEALING MATERIALS STANDARDS.

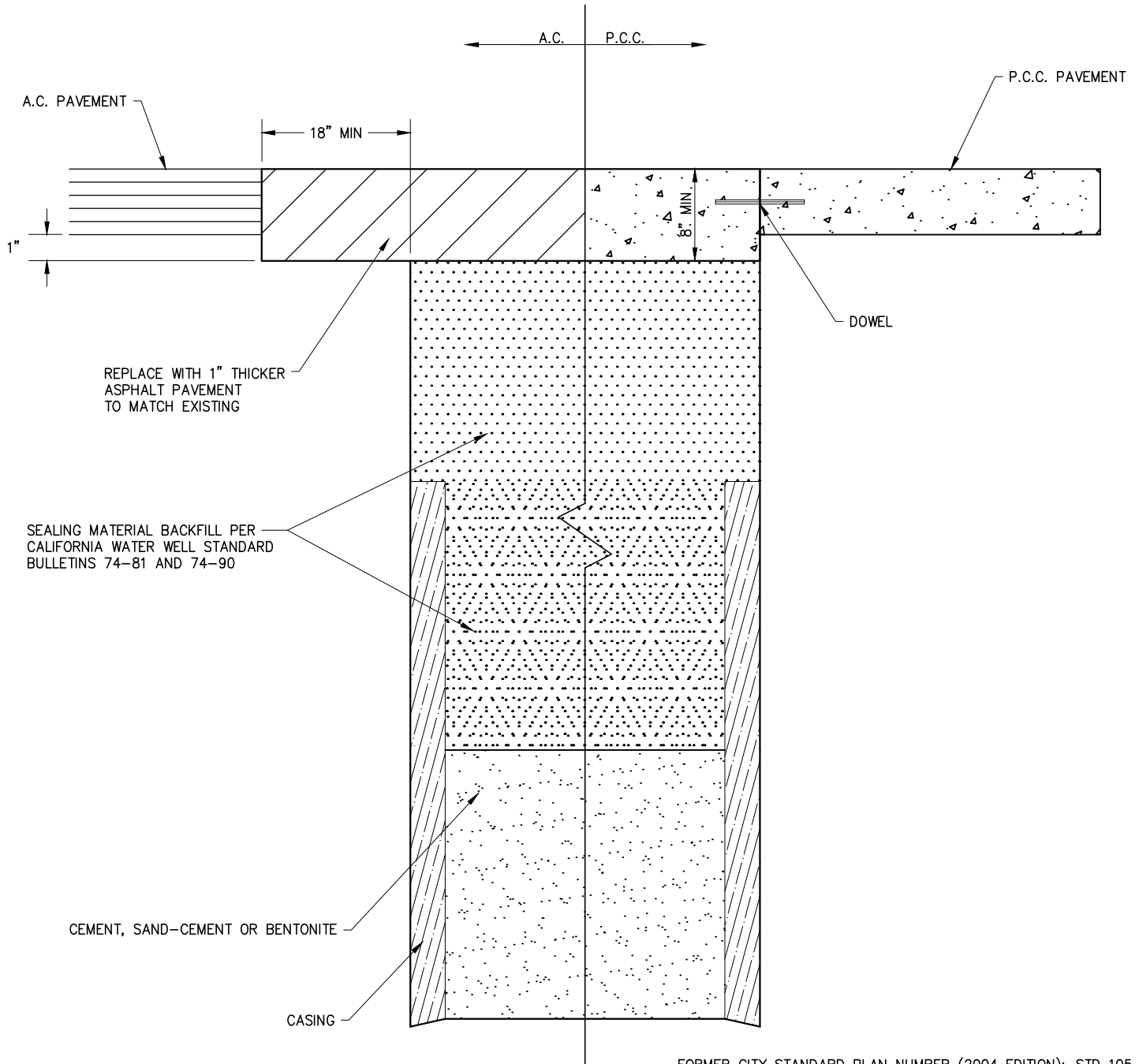

FORMER CITY STANDARD PLAN NUMBER (2004 EDITION): STD 105-L-G

APP. <i>James M. Hinkle</i>	51568	11/24/2020		
CITY ENGINEER	RCE	DATE	NO.	DATE
			DESCRIPTION OF REVISIONS	

CITY OF NEWPORT BEACH DEPARTMENT OF PUBLIC WORKS

DRAWN: P. KHARAZMI

DATE: 11/3/2020

MONITORING WELLS CAPPING DETAIL

STANDARD DRAWING NO.

106-E

SHEET 1 OF 1