

PROPOSED BOUNDARY
UNDERGROUND UTILITIES DISTRICT NO. 19
CITY OF NEWPORT BEACH
COUNTY OF ORANGE, STATE OF CALIFORNIA
SANTA ANA HEIGHTS - MESA DRIVE & CYPRESS STREET

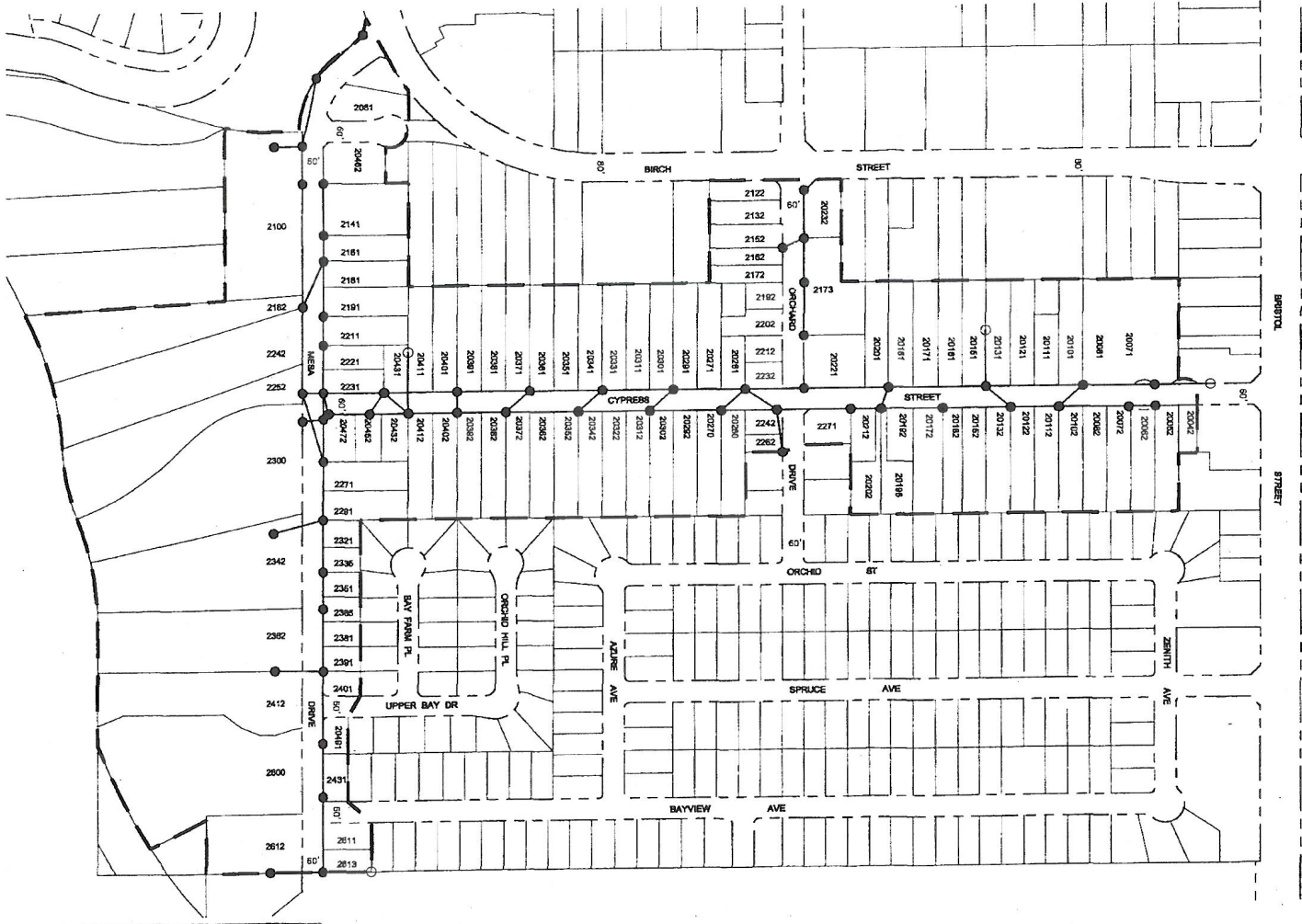

UNDERGROUND UTILITIES DISTRICT NO. 19 WAS FORMED BY AN ACTION OF THE CITY COUNCIL, DESCRIBED BY A MINUTE ORDER DATED _____, 20__.

STEPHEN G. BADUM, P.E.
PUBLIC WORKS DIRECTOR

LEGEND

- POLES TO BE REMOVED
- POLES TO REMAIN IN PLACE
- OVERHEAD LINES TO BE REMOVED
- - - DISTRICT BOUNDARY

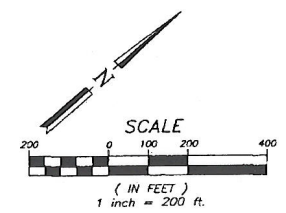

DATE: _____

PREPARED BY:
GFB-FRIEDRICH & ASSOC., INC.
CONSULTING CIVIL ENGINEERS
6529 RIVERSIDE AVENUE, STE. 230
RIVERSIDE, CA 92506
(951) 781-0811