



PUBLIC WORKS

April 2022 Update

Project Fact Sheet

Assessment District 111

ABOUT THIS PROJECT

The underground in your project area bounded by Newport Boulevard, 23rd Street, Ocean Front Way and 31st Street (see boundary map on back) has been on going. Work includes undergrounding all overhead utilities in the public right of way for the project area. Reconstruction of concrete alleys and paved areas will also occur. Total project costs are approximately \$3.5 million. Undergrounding along Balboa Boulevard is encompassed by the Southern California Edison Rule 20A program and is completed at no additional cost to property owners. This effort along Balboa Boulevard between 36th St and 23rd St is known as UUD – Phase 2.

WHEN WILL CONSTRUCTION BE COMPLETED?

The City Council awarded the construction contract of AD 111 and UUD – Phase 2 to Asplundh Construction on August 25, 2020. Construction began in September 2020 and was completed in November 2021. Asplundh installed conduit and vaults for SCE, AT&T, Spectrum, MCI, Verizon, and Crown Castle, with only minor delays due to COVID-19 pandemic.

AD 111 property owners were notified in August 2021 to begin their residential conversions. Once 90% of conversions are completed, SCE will begin their cutover work. It is anticipated that 90% will be reached before Memorial Day 2022. **Delays have been realized due to supply chain issues.**

AT&T and Spectrum will pull their wires to the homes once all of the residential conversions are complete and underground conduits are installed for them to utilize. Once all power, phone and cable lines are installed to each home the wires and poles can be removed.

Finally, the City will restore all impacted alleys either in the Spring or the Fall of 2023 depending on progress made by the residents. Balboa Blvd will also be completely resurfaced under a separate construction contract.

STAY INFORMED

Get more information from the City of Newport Beach at: www.newportbeachca.gov/ADstatus. **If you would like E-mail updates on this district please send that request to PWinfo@Newportbeachca.gov to get on the list.**



TENTATIVE SCHEDULE:

- **Construction:**
 - Residential Conversion - Fall 2021 thru Spring 2022
 - Utility Conversions – Summer/Fall 2022
 - Pole Removal – thru Winter 2022
 - Alley Reconstruction – Spring 2023 thru Fall 2023

FUNDING SOURCE:

- Assessment District Funds
- Rule 20A Funds

PROJECT CONTACTS:

- Public Works Department
(949) 644-3311
- Michael J. Sinacori
Assistant City Engineer
msinacori@newportbeachca.gov
(949) 644-3342
- Anna Baldenegro
Associate Civil Engineer
abaldenegro@newportbeachca.gov
(949) 644-3034

ASSESSMENT DIAGRAM FOR
 ASSESSMENT DISTRICT NO. 111
 (NEWPORT BLVD/23RD ST/OCEAN FRONT W/ 31ST ST)
 CITY OF NEWPORT BEACH, COUNTY OF ORANGE
 STATE OF CALIFORNIA

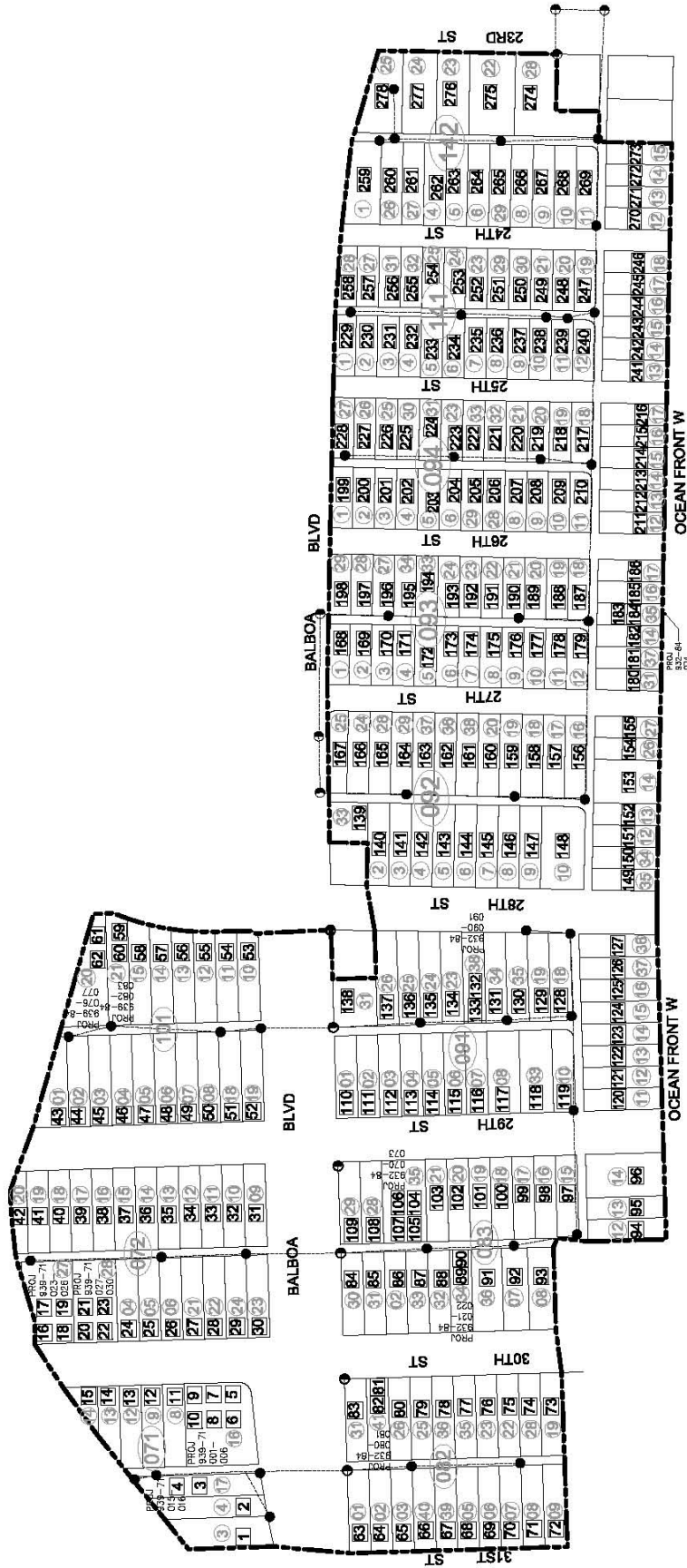

- WIRES TO BE REMOVED
- - - ASSESSORS PARCEL LINE
- ASSESSMENT DISTRICT BOUNDARY
- POLE TO BE REMOVED
- RULE 20A TO BE REMOVED
- ASSESSORS PARCEL NUMBER
- ASSESSORS PAGE SECTION
- 1 ASSESSMENT NUMBER

